

LO/AN

Pipe Type Reel Seat **BACK STOP**®



Lock Nut for DPS-SD/ASH (with New "Collar" Structure)

SD用ロックナット(カラー付き)

Newly developed "LOCK NUT" for double-nut system. All parts are made of Reinforced plastics. BACKSTOP-mechanism to minimize the loosening by adopting new "Collar" structure. Exclusively designed for DPS-SD/ASH.

新ダブルナットシステム用ロックナット。オール樹脂製。カラーによって緩みを最少に抑えるBACK STOP機構。

DPS-SD/ASH専用設計

Size Chart

Size	L1 mm	L2 mm	I/D1 mm	I/D2 mm	O/D mm	W mm
16	10.60	7.0	17.55	18.65	22.5	1.35
17	10.60	7.0	19.25	20.35	24.2	1.85
18	12.20	8.6	20.25	21.40	25.4	1.85
20	12.25	8.7	22.50	23.40	27.3	1.85
22	12.25	8.7	24.25	25.35	29.3	1.85
24	12.30	8.7	26.25	27.35	31.7	1.85

Size	LOGR/AN
16	
17	
18	
20	
22	
24	

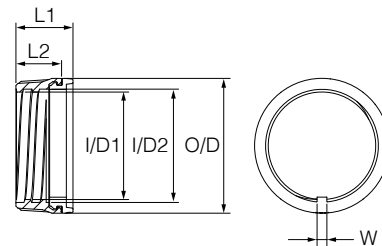

Example 表記例

•LOGR16/AN

Maximum Opening Length between the Hood

フードの最大開口寸法

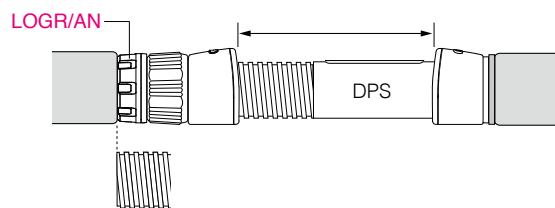

LOGR16/AN + DPS16	56.5mm
LOGR17/AN + DPS17	58.5mm
LOGR18/AN + DPS18	61.0mm
LOGR20/AN + DPS20	60.0mm
LOGR22/AN + DPS22	60.0mm
LOGR24/AN + DPS24	62.0mm

The length is measured when LOGR/AN is at the end of DPS body.

LOGR/ANが、DPSボディの端にある状態での長さです。

All made of Reinforced Plastics

オール樹脂製

